

Department of Medical Education



"To Teach is to Touch a Life Forever"



**Nicklaus
Children's
Hospital**



Welcome



Welcome to the Medical Education Department at Nicklaus Children's Hospital (NCH). The Department is committed to the oversight and provision of high-quality, evidence-based, and innovative Continuing Medical Education (CME), Graduate Medical Education (GME), and Undergraduate Medical Education (UME). NCH extends its medical education impact beyond Florida through our educational initiatives in the USA and across the world. The hospital has a strong history of commitment to medical education at all levels in the USA and beyond. Our faculty members are strongly committed to lifelong learning, personal and professional development, and professional and

scholarly work. Our medical education programs are based on Adult Learning Principles. Teaching is done using multiple modalities including: live didactic lectures, workshops, multidisciplinary conferences, web-based technology, and simulation.

The Medical Education Department is responsible for:

1. Oversight and maintenance of compliance with accreditation requirements for the institution, CME, GME, and UME programs
2. Planning and implementation of educational initiatives
3. Faculty development
4. Partnership and collaboration with local, regional, national, and worldwide educational institutions.

Thank you for considering NCH Medical Education Department as a source for your medical education needs. We're Here for the Children!

Rani S Gereige, MD, MPH, FAAP
Executive Director of Medical Education
Designated Institutional Official (DIO)
DEI Lead
Nicklaus Children's Health System
Nicklaus Children's Hospital

About Nicklaus Children's Hospital



Founded in 1950, Nicklaus Children's Hospital® is South Florida's only licensed free-standing specialty hospital exclusively for children. The not-for profit 501 (C) (3) 289-bed hospital is renowned for excellence in all aspects of pediatric medicine with several specialty programs ranked among the best in the nation in the rankings by *U.S. News & World Report*. In March 2015 the hospital name was changed from Miami Children's Hospital to Nicklaus Children's Hospital

Several of Nicklaus Children's Hospital (NCH) pediatric specialty services are ranked each year among the best in the nation, according to *U.S. News & World Report's "America's Best Children's Hospitals"*. NCH has more programs included in the pediatric rankings than any other hospital in Florida.

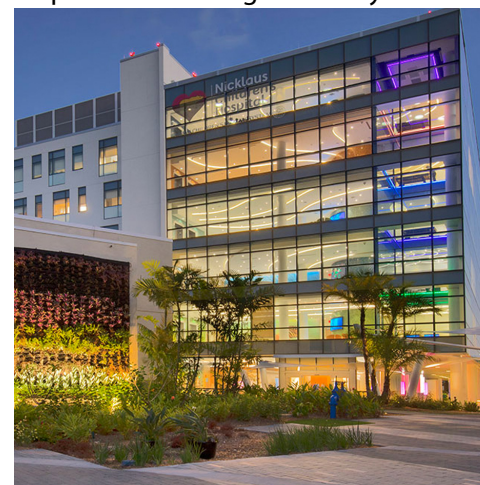

The hospital has also been designated an **American Nurses Credentialing Center (ANCC) Magnet** facility, the nursing profession's most prestigious institutional honor and is home to the largest pediatric teaching program in the southeastern United States.



Continuing Medical Education (CME)



ACCREDITED WITH
COMMENDATION

Nicklaus Children's Hospital is a CME provider accredited by the Accreditation Council for Continuing Medical Education (ACCME) With Commendation. NCH provides several regularly scheduled series (RSS) and yearly conferences at NCH and in the community.

Continuing Medical Education (CME) consists of educational activities which serve to maintain, develop, or increase the knowledge, skills, and professional performance and relationships that a physician uses to provide services for patients, the public, or the profession. The content of CME is that body of knowledge and skills generally recognized and accepted by the profession as within the basic medical sciences, the discipline of clinical medicine, and the provision of health care to the public.

EVENTS: For Complete Listing of Events and to Manage Your Portfolio go to **iLearn Platform** (<http://www.iLearnPeds.com>)

Regularly Scheduled Series (RSS):

- a. Pediatric Grand Rounds** – (Weekly) on Fridays 8:00am-9:00am (NCH Auditorium)
- b. Radiology Conference** – (Weekly) on Wednesdays 8:15am-9:15am (NCH Auditorium)
- c. Faculty Development Seminars** – Held Quarterly and aimed to train-the-trainers on various academic topics from teaching, to giving feedback, to mentoring trainees, and personal and professional growth.
- d. Trauma Conference.**
- e. Practical Community Pediatrics (PCP) CME Series** – Held Quarterly in the community to bring up-to-date information for the practicing generalist.
- f. Tumor Board.**



Yearly Live Conferences:

NCH Department of Medical Education provides CME Conferences in the community. These are yearly conferences aimed at various target audiences from the general pediatrician to the pediatric subspecialist. These conferences include:

- a. The Pediatric Post-Graduate Course (PPGC)** – Held yearly in the winter in Miami. This conference is in its 60th year and attracts over 250 attendees (50% of whom are international).
- b. The Virtual e-PPGC** – The live PPGC is transmitted live to multiple counties across the globe taking Pediatric Education beyond any limits using technology in education.
- c. NCH Annual General Pediatric Review & Self-Assessment Course** – This course serves as an intense review of Pediatrics to help prepare first-time takers and re-certifiers of the Board certification examination.

Accreditation Statement: *Nicklaus Children's Hospital is accredited by the Accreditation Council for Continuing Medical Education to provide continuing medical education for physicians.*

Faculty/Planner Disclosure Policy: *In accordance with the Accreditation Council for Continuing Medical Education's Standards for Commercial Support, all planners, teachers, and authors involved in the development of CME content are required to disclose to the accredited provider their relevant financial relationships. Relevant financial relationships will be disclosed to the activity audience.*

Graduate Medical Education (GME)

Nicklaus Children's Hospital Graduate Medical Education (GME) Programs provide a State of the Art high-quality General Pediatric and Pediatric Subspecialty training that is highly recognized and accredited by the Accreditation Council of Graduate Medical Education and other educational organizations.

Our goal is to provide an optimal learning environment for the acquisition of the knowledge, skills, and attitudes by our graduates, in order to achieve the highest levels of personal and professional accomplishments in their field.

NCH is home to the Largest Pediatric Residency Program in the Southeast of the USA. Our Pediatric Residency Program is fully accredited by the Accreditation Council for Graduate Medical Education (ACGME), with participation limited to 84 residents and two chief residents. The focus of the program is to prepare residents for a lifetime of quality practice either in primary care pediatrics or in the subspecialty of their choosing. Our graduates boast the highest board pass rate in first time takers on the American Board of Pediatric Certifying examination among all the Pediatric Residency Programs in the State of Florida for the past three years and more. NCH Graduates secure subspecialty fellowship training positions in centers of academic excellence across the nation.

In addition to training in General Pediatrics, the GME Department offers training in a variety of subspecialties through our Fellowship Training Programs. NCH sponsors fellowship in the following subspecialties:

- | | |
|-------------------------------------|-----------------------------------|
| 1) Adolescent Medicine | 12) Pediatric Urology |
| 2) Pediatric Critical Care Medicine | 13) Craniofacial Plastic Surgery |
| 3) Pediatric Cardiology | 14) Clinical Neurophysiology |
| 4) Pediatric Emergency Medicine | 15) Child Neurology |
| 5) Pediatric Surgery | 16) Cardiac Intensive Care |
| 6) Pediatric Radiology | 17) Pediatric Hospital Medicine |
| 7) Pediatric Gastroenterology | 18) Allergy-Immunology |
| 8) Clinical Biochemical Genetics | 19) Pediatric Orthopedic Spine |
| 9) Child & Adolescent Psychiatry | 20) Pediatric Hematology-Oncology |
| 10) Pediatric Hematology-Oncology | 21) Pediatric Neurosurgery |
| 11) Pediatric Orthopedic Surgery | |

NCH is also a pediatric training site for over 200 rotating residents and subspecialty residents per year from participating institutions such as Cleveland Clinic of Florida, Jackson Memorial Hospital, University of Miami, Mt. Sinai Medical Center, Nova Southeastern University, Larkin Medical Center, HCA, Florida International University, and other facilities. The GME program offers electives for visiting residents and fellows from ACGME-accredited programs across the USA & Canada.

Undergraduate Medical Education (UME)

Nicklaus Children's Hospital is the site for Third Year Core Pediatric Clerkships for Medical Students from our three Medical School Affiliates: Florida International University College of Medicine (FIU), Nova Southeastern University (NSU), and St. George's University (SGU). During their Pediatric Clerkship, medical students rotate in the Emergency Department, on inpatient and outpatient services in both General Pediatric and Pediatric Subspecialty Services. The medical students' curriculum is designed with a blend of clinical experiences, didactic sessions, small group discussions, interactive, and self-directed learning. The

curriculum is based on the Pediatric Curriculum designated by the Council on Medical Students in Pediatrics (COMSEP) and is meant to assist the parent institutions to meet the accreditation of the Liaison Committee on Medical Education (LCME) or the American Osteopathic Association (AOA). All student rotations are supervised by our faculty.

Only third year students from our affiliated medical schools are eligible to take their core pediatric clerkship at NCH. However, NCH offers 4th year electives in various subspecialties to 4th year medical students from LCME or AOA-Accredited Medical Schools in the US and Canada based on availability. Applications are accepted through the AAMC VSAS.



Innovations in Medical Education



iLearnPeds: NCH Virtual CME Library – Taking NCH Educational Excellence to the Learners’ Fingertips

NCH is committed to bring the excellence in education to the learner’s fingertips. Through the use of technology in education, iLearnPeds was created. It is a virtual library that allows the attendee anywhere in the world to tap into live transmission of our Continuing Education Courses as well view the videos on demand on any desktop, laptop, ipad, mobile device, tablet.

The Virtual library is designed with the practicing physician in mind to bring the latest topics in General and Subspecialty Pediatrics from our award winning service lines in Neurology, Cardiology, and other topics. The platform is CME-compliant and allows the attendee to claim Continuing Education Credit Sponsored by NCH CME department. To access the iLearnPeds Virtual Library, go to: <http://www.ilearnpeds.com>

NICKLAUS CHILDREN’S HOSPITAL ACCOUNT LOGIN

I have a Nicklaus Children’s Hospital username and password.

NICKLAUS CHILDREN’S HOSPITAL LOGIN ▶

First-Time NCH Users: Log-in With NCH Credentials

Visitors can create an account using their email addresses. The account provides access to the virtual library.

VISITOR LOGIN

I do not have a Nicklaus Children’s Hospital username and password.

VISITOR LOGIN ▶

CREATE NEW VISITOR ACCOUNT ▶

Pediatric Human Patient Simulation Program - Enhancing pediatric healthcare training through medical simulation.

As part of its commitment to excellence in pediatric healthcare, Nicklaus Children’s Hospital has developed a state-of-the-art Pediatric Human Patient Simulation Program to support healthcare trainees and professionals in developing and enhancing skills required to provide medical assessment and treatment of children.

The program features a high-fidelity child-sized mannequin with computerized medical simulation that has the capability to mirror the physiologic parameters and medical responses of a young patient. The program also features two infant sized medium fidelity simulators as well. This technology provides a superior learning environment for health care professionals



Simulation technology offers many benefits. It enables healthcare professionals and students to practice relevant pediatric scenarios and acquire basic pediatric care skills. Specifically, it can support healthcare students and professionals in:

- Improving teamwork and building team-leading skills
- Enhancing communication skills
- Developing and improving critical-thinking skills
- Practicing new procedures or testing new equipment
- Enhancing medication administration safety
- Administering medications based on pediatric dosing
- Improving patient assessment and bedside decision making
- Enhancing competency-based assessment skills
- Practicing infrequently used emergency treatment skills

Simulation Scenarios Enhance Education

Simulation is an outstanding tool for acquiring diagnostic skills and practicing medical procedures. Simulation scenarios can range widely in complexity. Some are used simply to review assessment skills, while others significantly alter the patient’s underlying physiologic status.

The following are examples of how the Pamela Garrison Simulator can be applied to enhance learning:

- Trainees can assess normal and abnormal heart sounds and breath sounds, perform neurological exams (including pupil response) and cardiovascular exams (including EKG interpretation, blood pressure and differentiation of bilateral pulses).
- Trainees can realistically intubate, start IV lines, cardiovert and defibrillate the simulator and immediately observe the simulator's response PediaSim® recognizes pharmacologic interventions and will react accordingly.
- BabySim & Simbaby both allow many additional procedures to be performed including insertion of chest tubes, needle thoracostomy and intraosseus needle placement.
- Instructors can customize a "patient" and isolate critical teaching modules to address a trainee's specific needs.
- Trainees can be exposed to unusual pediatric emergency situations, allowing them to acquire infrequently used skills and practice them without risk to a real child. In such scenarios, the computer system allows reality to be suspended. PediaSim® becomes a real child undergoing a real emergency.

Programs and Customized Courses

Multiple course offerings now can incorporate the pediatric simulation as part of the curriculum.

In addition, the Nicklaus Children's Pediatric Patient Simulator Lab staff can tailor specific training programs to fulfill requests from area healthcare educators, including nursing and allied health professional instructors. The Lab is also available to parents and other caregivers for children with special needs. Pharmaceutical and medical device companies, as well as others interested in research projects, are also encouraged to find out more about the Simulator Lab at Nicklaus Children's Hospital.

The Pediatric Human Patient Simulation Program is made possible through a generous grant from Peacock Foundation. The Pamela Garrison Simulator has been funded by South Florida philanthropist R. Kirk Landon. The purchase of BabySim has been funded by grant from the Hugoton Foundation.

Research



The Department of Medical Education works closely with NCH Research Institute to support clinical and translational research across the institution with the goal of advancing the care of children. The Brain Institute is engaged in many cutting edge research projects aimed at new discoveries and technological

improvement. The NCH Residents and Fellows are engaged in Research Projects mentored by faculty as well as Quality Improvement Projects. Each year, the department of Medical Education and the Research Institute hold a Research and Scholarship day to disseminate the high quality research projects conducted at NCH.



Thank You

We thank you for taking the time to be familiar with the excellence in clinical care, teaching, training, innovation, and research that Nicklaus Children's Hospital and its various departments provide. Please feel free to contact us for questions.



Nicklaus Children's Health System



Nicklaus Children's Hospital

Resources

For More Information



Milestones in Medical Education Newsletter

<https://www.nicklauschildrens.org/medical-professionals/medical-education/milestones-newsletter>



<http://www.facebook.com/NicklausMedEd>



<http://www.Twitter.com/NicklausMedEd>



<http://www.Instagram.com/NicklausMedEd>

We're on the Web!

<http://www.nicklauschildrens.org/medicaleducation>

E-Mail

CME@Nicklaushealth.org

PHONE

(305) 669-5873

FAX

(305) 669-6531

